



Collection: MODULO

Finish*:



NF - Neutral

Main features:



Features

- **DIMENSIONS:** 32.50 x 25.90 x 18.90 cm
- **MATERIAL:** N/A
- **SHOWER TAPS-CLASSIFICATION:** MECHANICAL
- **WARRANTY DURATION (YEARS):** 5
- **SUPPLY TEMPERATURE:** Hot water temperature between 55 and 65°C, 60°C is recommended
- **WEIGHT:** 2 kg
- **INSTALLATION TYPE:** Built-in
- **SINGLE-LEVER TAPS:** MECHANICAL
- **WORKING PRESSURE:** Working pressure between 1 and 6 bars, recommended pressure 3 bars

Consumer benefits

- **WIDE CHOICE:** Coordinates with a wide choice of trims
- **PERFECT SEAL:** Leaking avoided due to perfect seal provided by box's plastic envelope
- **NO POROSITY OR CRACKING:** Metal body in de-zinc resistant brass provides a structure with no porosity or cracking for a perfect seal
- **EASY MAINTENANCE:** Direct access to valve servicing parts by removing trim
- **EASY VALVE AND TRIM CHANGE:** Option to switch from mechanical to thermostatic mode

Installation benefits

- **ESTHETIC AND PERFECT ALIGNMENT:** Connector available to join two Modulo universal boxes
- **VARIOUS INSTALLATION OPTIONS:** Can be installed on different wall types with recess depth between 80 and 100 cm (tiling included)
- **INSTALLATION ON DIFFERENT SURFACES:** walls in concrete, plaster, wood, industrial partitions, etc.
- **ADAPTABLE VALVES:** Designed for thermostatic valves, mechanical valves, diverters, etc.
- **INTEGRATED LEVEL:** Easier box positioning
- **CUTOUT TEMPLATE INCLUDED:** Box cover with prongs to use as template

Technical drawing

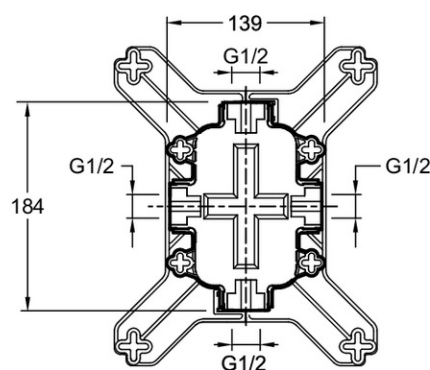
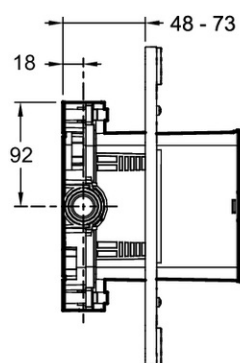
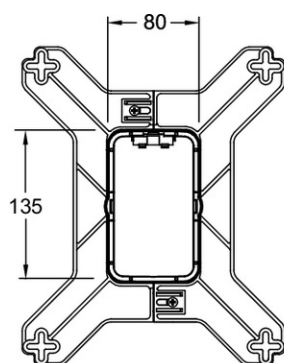

Product Specification: Universal recessed box. 98699D. Collection: MODULO. DIMENSIONS: 32.50 x 25.90 x 18.90 cm. WEIGHT: 2 kg. MATERIAL: N/A. INSTALLATION TYPE: Built-in. SHOWER TAPS-CLASSIFICATION: MECHANICAL. SINGLE-LEVER TAPS: MECHANICAL. WARRANTY DURATION (YEARS): 5. WORKING PRESSURE: Working pressure between 1 and 6 bars, recommended pressure 3 bars. SUPPLY TEMPERATURE: Hot water temperature between 55 and 65°C, 60°C is recommended.