



Collection: ODÉON UP

Finish*:



00 - Gloss White

Main features:



Features

- **DIMENSIONS:** 67 x 36.50 cm
- **MATERIAL:** Ceramic
- **NORMS AND REGULATIONS:** NF
- **EVACUATION:** P-trap
- **WATER CONSUMPTION:** Standard 3/6 L
- **RIM TYPE:** Open (traditional)
- **SEAT TYPE:** Standard
- **SUPPLIED:** Thermoset toilet seat, metal hinges 8407K; rapid floor fixing kit
- **WEIGHT:** 38.4 kg
- **INSTALLATION TYPE:** Floor-standing
- **LENGTH:** Standard
- **SHAPE:** Round
- **HEIGHT:** Comfort
- **WATER CONNECTION:** side inlet
- **MECHANISM GUARANTEE:** 2 years

Consumer benefits

- **SOUND COMFORT:** Class 1 float valve
- **MECHANISM:** Complete factory-fitted cistern with water-saving 3/6 L flush

Installation benefits

- **EASIER INSTALLATION:** Quick-mount system

Technical drawing

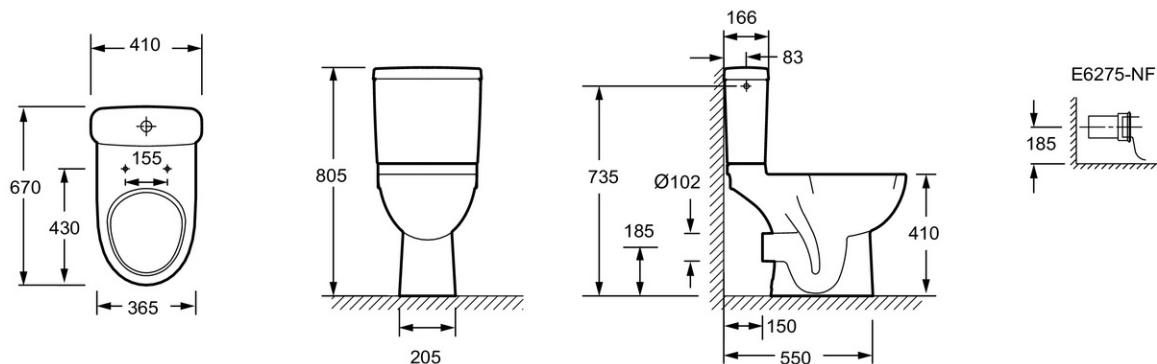

Product Specification: WC pan pack, P-trap. E0520. Collection: ODÉON UP. DIMENSIONS: 67 x 36.50 cm. WEIGHT: 38.4 kg. MATERIAL: Ceramic. INSTALLATION TYPE: Floor-standing. NORMS AND REGULATIONS: NF. LENGTH: Standard. EVACUATION: P-trap. SHAPE: Round. WATER CONSUMPTION: Standard 3/6 L. HEIGHT: Comfort. RIM TYPE: Open (traditional). WATER CONNECTION: side inlet. SEAT TYPE: Standard. MECHANISM GUARANTEE: 2 years. SUPPLIED: Thermoset toilet seat, metal hinges 8407K; rapid floor fixing kit.