



Collection: SINGULIER

Finish*:



CP - Chrome

Main features:



Features

- **WEIGHT:** 4.6 kg
- **INSTALLATION TYPE:** 2 holes
- **TYPE:** Single-lever
- **CONNECTION:** With pillar connectors & O-rings
- **HOLE CONFIGURATION:** 150
- **SAFETY STOP:** 40°C
- **MECHANISM GUARANTEE:** 5 years
- **MATERIAL:** Metal
- **NORMS AND REGULATIONS:** NF : II/A - ECAU : E3/1 C3 A1 U3
- **FLOW RATE:** 20 l/mn
- **MECHANISM:** Expandable wax thermostatic cartridge
- **SHOWER TAPS-DIVERTER:** Automatic diverter built into flow handle
- **WARM BODY:** Yes

Technical drawing

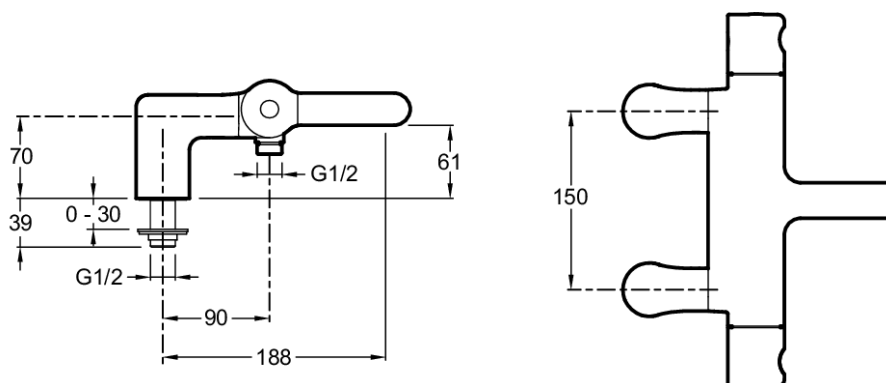

Product Specification: Thermostatic deck-mount bath/shower mixer. E10871. Collection: SINGULIER. WEIGHT: 4.6 kg. MATERIAL: Metal. INSTALLATION TYPE: 2 holes. NORMS AND REGULATIONS: NF : II/A - ECAU : E3/1 C3 A1 U3. TYPE: Single-lever. FLOW RATE: 20 l/mn. CONNECTION: With pillar connectors & O-rings. MECHANISM: Expandable wax thermostatic cartridge. HOLE CONFIGURATION: 150. SHOWER TAPS-DIVERTER: Automatic diverter built into flow handle. SAFETY STOP: 40°C. WARM BODY: Yes. MECHANISM GUARANTEE: 5 years.