



Collection: JULY

Finish*:



CP - Chrome

Main features:



Features

- **WEIGHT:** 1.9 kg
- **INSTALLATION TYPE:** 2 holes
- **TYPE:** Single-lever
- **CONNECTION:** With connectors and wall escutcheons
- **SHOWER TAPS-WATER/ENERGY SAVING:** Yes
- **SHOWER TAPS-DIVERTER:** Automatic diverter with locking feature
- Non-return valve on shower outlet

- **MATERIAL:** Metal
- **NORMS AND REGULATIONS:** NF : IC/A - ECAU : E3/1 C2 A2 U3 - Ge3
- **FLOW RATE:** 21 l/mn
- **HOLE CONFIGURATION:** 150 ± 15
- **WASTE :** Without
- **MECHANISM GUARANTEE:** 5 years
- Automatic diverter with locking feature

Consumer benefits

- Sensitive flow control

Installation benefits

- **EASY INSTALLATION :** Connectors and wall escutcheons

Technical drawing

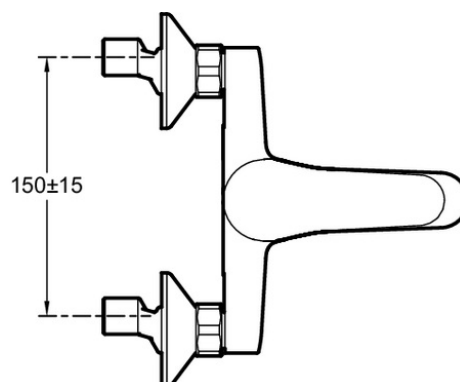
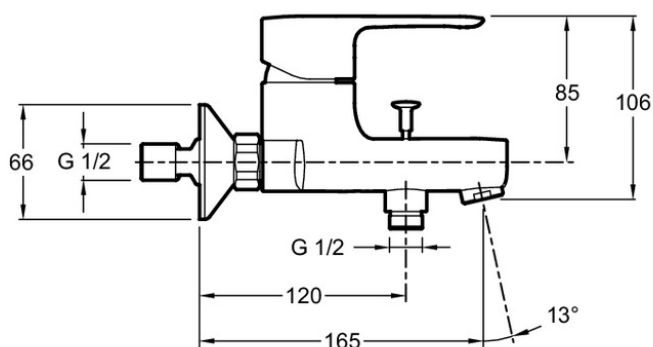

Product Specification: Single-lever wall-mount bath/shower mixer. E16033-4. Collection: JULY. WEIGHT: 1.9 kg. MATERIAL: Metal. INSTALLATION TYPE: 2 holes. NORMS AND REGULATIONS: NF : IC/A - ECAU : E3/1 C2 A2 U3 - Ge3. TYPE: Single-lever. FLOW RATE: 21 l/mn. CONNECTION: With connectors and wall escutcheons. HOLE CONFIGURATION: 150 ± 15. SHOWER TAPS-WATER/ENERGY SAVING: Yes. WASTE : Without. SHOWER TAPS-DIVERTER: Automatic diverter with locking feature. MECHANISM GUARANTEE: 5 years. Non-return valve on shower outlet. Automatic diverter with locking feature.