

E22BW90

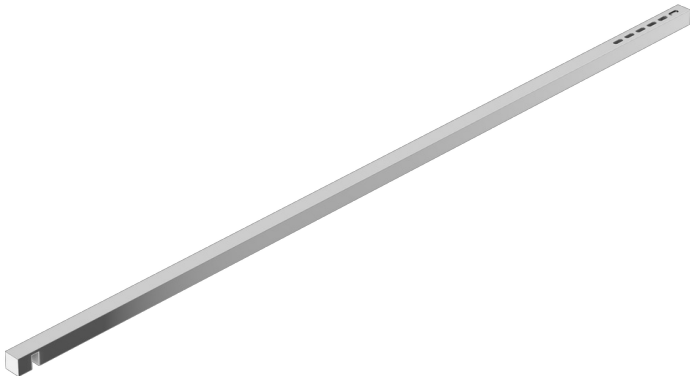

Collection: CONTRA

Finish\*:



BL - Matte Black



GA - Bright Anodised

Main features:

Features

- WEIGHT: 1 kg
- MATERIAL: Aluminium
- INSTALLATION TYPE: Wall-mount
- TRIMMABLE: Yes

Product Specification: Horizontal bar. E22BW90. Collection: CONTRA. WEIGHT: 1 kg. MATERIAL: Aluminium. INSTALLATION TYPE: Wall-mount. TRIMMABLE: Yes.

*\*Due to possible variations in computer and printer calibrations, technical factors and certain finish characteristics, the colors you see may not accurately portray the actual colors and are provided as a guide only.*