

E0 - Single-lever kitchen sink mixer

Jacob Delafon
PARIS

E24161



Collection: E0

Finish*:



CP - Chrome

Main features:



Features

- DIMENSIONS: 14.60 cm
- INSTALLATION TYPE: 1 hole
- FLOW RATE: 15 l/mn
- SPOUT PROJECTION: 218
- WEIGHT: 1.9 kg
- TYPE: Single-lever
- HEIGHT UNDER SPOUT: 146
- WARRANTY DURATION (YEARS): 5

Technical drawing

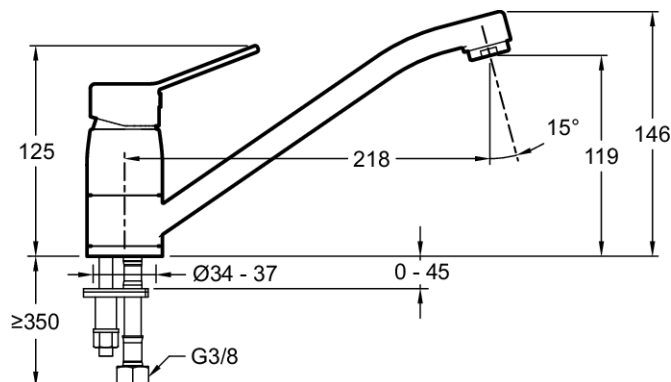

Product Specification: Single-lever kitchen sink mixer. E24161. Collection: E0. DIMENSIONS: 14.60 cm. WEIGHT: 1.9 kg. INSTALLATION TYPE: 1 hole. TYPE: Single-lever. FLOW RATE: 15 l/mn. HEIGHT UNDER SPOUT: 146. SPOUT PROJECTION: 218. WARRANTY DURATION (YEARS): 5.

*Due to possible variations in computer and printer calibrations, technical factors and certain finish characteristics, the colors you see may not accurately portray the actual colors and are provided as a guide only.

www.jacobdelafon.com

This document is not contractual