



**Collection:** NO COLLECTION

**Finish\*:**



NF - Neutral

**Main features:**



### Features

- **DIMENSIONS:** 50 x 18 cm
- **MATERIAL:** N/A
- **NORMS AND REGULATIONS:** NF
- **FLUSH MECHANISM:** Dual flush
- **QUIET MECHANISM:** Class 1
- **SUPPORT FRAME MATERIAL:** Steel
- **SUPPORT FRAME FIXINGS:** 1
- Control panel not included

- **WEIGHT:** 17 kg
- **INSTALLATION TYPE:** Wall-mount
- **SUPPORT FRAME GUARANTEE:** 5 years
- **WATER CONSUMPTION:** Standard 3/6 L
- **CISTERN SOUND AND HEAT INSULATION:** Yes
- **QUIET FLOAT VALVE:** Yes
- Provided with a set of wall fasteners

### Consumer benefits

- **DURABLE:** Reinforced corrosion-resistant chassis around the pipe, tank insulated against condensation
- **RELIABLE:** NF certification applied

### Installation benefits

- **QUICK INSTALLATION:** single wall-fastening system
- **EASY INSTALLATION:** Self-locking base - maintains position once set to 0-20 cm (fall brake), base installed in the direction of installation

### Technical drawing

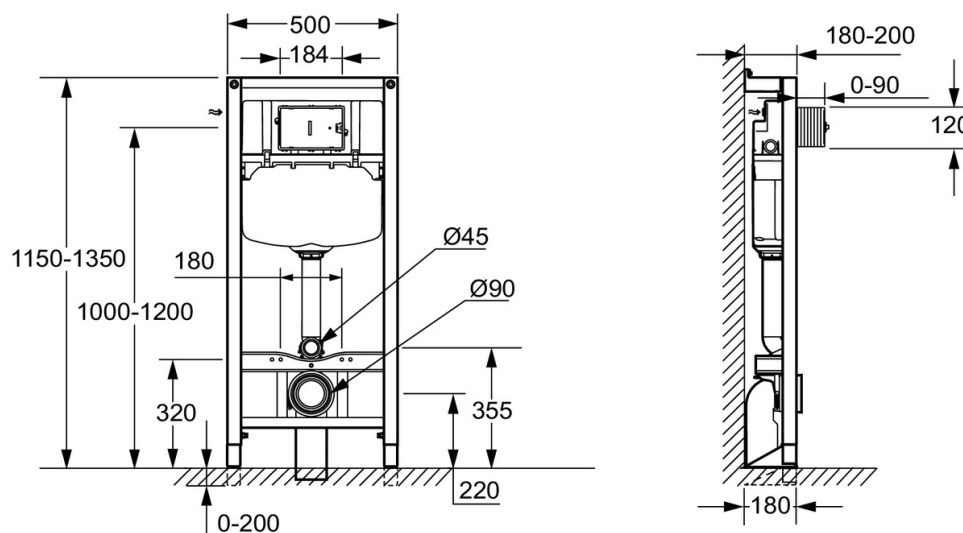

Product Specification: Support frame. E34195. Collection: NO COLLECTION. DIMENSIONS: 50 x 18 cm. WEIGHT: 17 kg. MATERIAL: N/A. INSTALLATION TYPE: Wall-mount. NORMS AND REGULATIONS: NF. SUPPORT FRAME GUARANTEE: 5 years. FLUSH MECHANISM: Dual flush. WATER CONSUMPTION: Standard 3/6 L. QUIET MECHANISM: Class 1. CISTERN SOUND AND HEAT INSULATION: Yes. SUPPORT FRAME MATERIAL: Steel. QUIET FLOAT VALVE: Yes. SUPPORT FRAME FIXINGS: 1. Provided with a set of wall fasteners. Control panel not included.