



**Collection:** CUFF

**Finish\*:**



CP - Chrome

**Main features:**



### Features

- **WEIGHT:** 1.4 kg
- **INSTALLATION TYPE:** 1 hole
- **TYPE:** Single-lever
- **HEIGHT UNDER SPOUT:** 163
- **CONNECTION:** With supply hoses
- **WASTE:** With
- Side lift rod
- Finger imprint on handle for better grip

- **MATERIAL:** Metal
- **NORMS AND REGULATIONS:** NF : I - ECAU : E00 Ch2 A3 U3 - Ps3 - ACS : 10 ACCLY 113
- **FLOW RATE:** 5 l/mn
- **SPOUT PROJECTION:** 99
- **MECHANISM:** Ceramic disc cartridge
- **MECHANISM GUARANTEE:** 5 years
- No base plate for easier cleaning
- Height under aerator: 82 mm

### Consumer benefits

- **SECURITY:** Temperature limiter ring
- **ANTI-SCALE:** Aerator included

### Installation benefits

- **DURABILITY:** PEX high-resistance supply hoses

### Technical drawing

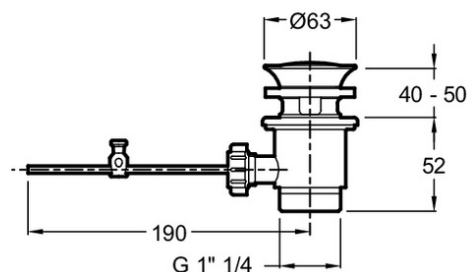
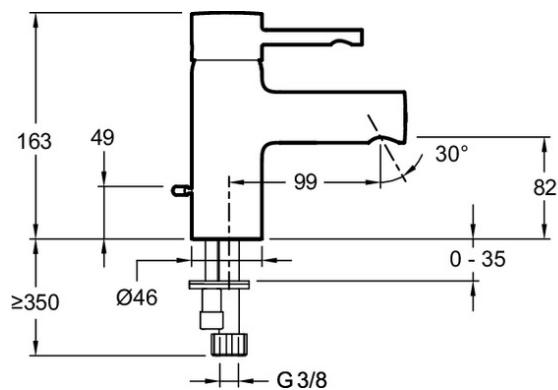

Product Specification: Single-lever washbasin mixer. E37041. Collection: CUFF. WEIGHT: 1.4 kg. MATERIAL: Metal. INSTALLATION TYPE: 1 hole. NORMS AND REGULATIONS: NF : I - ECAU : E00 Ch2 A3 U3 - Ps3 - ACS : 10 ACCLY 113. TYPE: Single-lever. FLOW RATE: 5 l/mn. HEIGHT UNDER SPOUT: 163. SPOUT PROJECTION: 99. CONNECTION: With supply hoses. MECHANISM: Ceramic disc cartridge. WASTE : With. MECHANISM GUARANTEE: 5 years. Side lift rod. No base plate for easier cleaning. Finger imprint on handle for better grip. Height under aerator: 82 mm.