



Collection: LOUIS

Finish*:



00 - Gloss White

Main features:



Features

- **DIMENSIONS:** 53.50 x 36 cm
- **MATERIAL:** Ceramic
- **LENGTH:** Standard
- **SUPPORT FRAME GUARANTEE:** 5 years
- **SEAT MATERIAL:** Thermoset
- **WATER CONSUMPTION:** 2.6/4 L and 3/6 L
- **RIM TYPE:** Rimless
- **QUIET MECHANISM:** Class 1
- **HINGES:** Metal
- **SEAT GUARANTEE:** 2 years
- **TOILET BOWL FIXINGS:** Supplied
- **WEIGHT:** 1 kg
- **INSTALLATION TYPE:** Wall-hung
- **SHAPE:** Round
- **FLUSH PLATE GUARANTEE:** 2 years
- **FLUSH MECHANISM:** Dual flush
- **HEIGHT:** Standard
- **SEAT TYPE:** Extra flat
- **SEAT :** With smooth, unclipable descent
- **CERAMIC GUARANTEE:** 10 years
- **MECHANISM GUARANTEE:** 2 years
- **QUIET FLOAT VALVE:** Yes

Consumer benefits

- **EASY MAINTENANCE:** Completely smooth and enameled toilet designed without flanges for complete accessibility and quick and thorough cleaning
- **EFFECTIVE RINSING:** Efficient water routing to the front of the toilet for optimal distribution to the edges while preventing splashing

Technical drawing

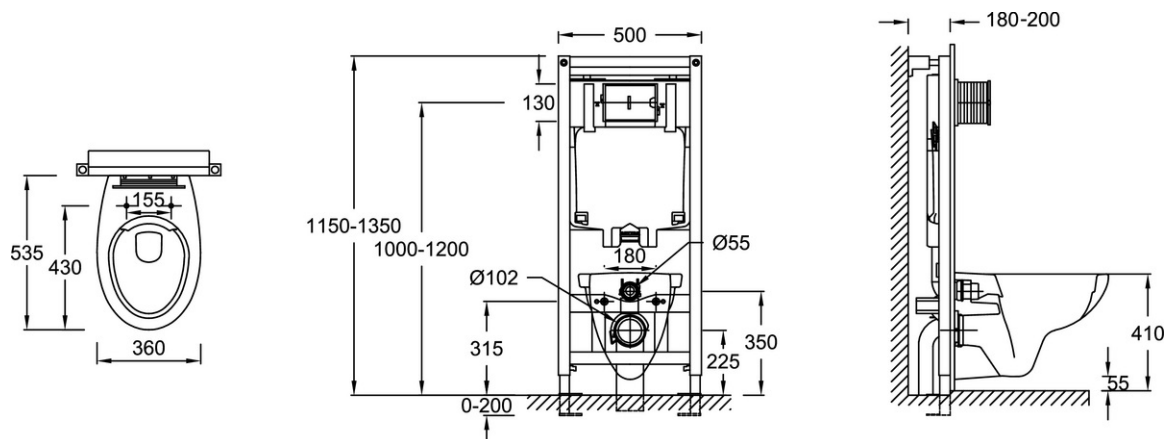

Product Specification: Wall-hung WC pan pack. E37652. Collection: LOUIS. DIMENSIONS: 53.50 x 36 cm. WEIGHT: 1 kg. MATERIAL: Ceramic. INSTALLATION TYPE: Wall-hung. LENGTH: Standard. SHAPE: Round. SUPPORT FRAME GUARANTEE: 5 years. FLUSH PLATE GUARANTEE: 2 years. SEAT MATERIAL: Thermoset. FLUSH MECHANISM: Dual flush. WATER CONSUMPTION: 2.6/4 L and 3/6 L. HEIGHT: Standard. RIM TYPE: Rimless. SEAT TYPE: Extra flat. QUIET MECHANISM: Class 1. SEAT : With smooth, unclipable descent. HINGES: Metal. CERAMIC GUARANTEE: 10 years. SEAT GUARANTEE: 2 years. MECHANISM GUARANTEE: 2 years. TOILET BOWL FIXINGS: Supplied. QUIET FLOAT VALVE: Yes.