

CUFF - Single-lever wall-mount bath/shower mixer

E45532

Jacob Delafon
PARIS

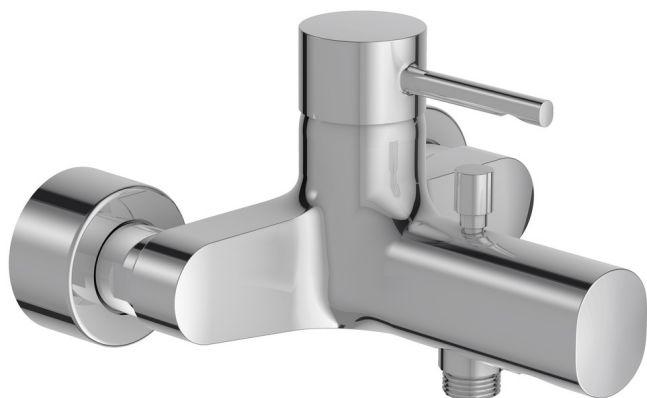

Collection: CUFF

Finish*:



CP - Chrome

Main features:



Features

- **WEIGHT:** 2.6 kg
- **INSTALLATION TYPE:** 2 holes
- **TYPE:** Single-lever
- **SPOUT PROJECTION:** 156 - 168
- **MECHANISM:** Ceramic disc cartridge
- **SHOWER TAPS-DIVERTER:** Automatic diverter with locking feature
- Non-return valve on shower outlet
- **MATERIAL:** N/A
- **NORMS AND REGULATIONS:** NF : IC/A - ECAU : E3/1 C2 A2 U3 - ACS : 10 ACCLY 004
- **FLOW RATE:** 20 l/mn
- **CONNECTION:** With connectors and wall escutcheons
- **HOLE CONFIGURATION:** 150 ± 15
- **MECHANISM GUARANTEE:** 5 years

Technical drawing

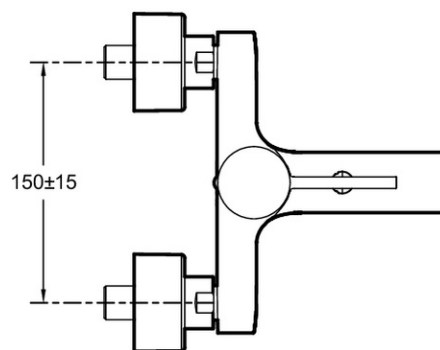
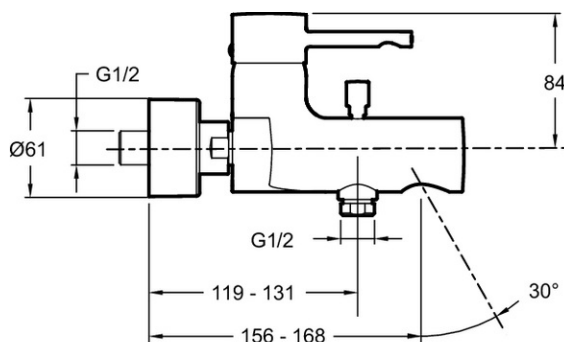

Product Specification: Single-lever wall-mount bath/shower mixer. E45532. Collection: CUFF. WEIGHT: 2.6 kg. MATERIAL: N/A. INSTALLATION TYPE: 2 holes. NORMS AND REGULATIONS: NF : IC/A - ECAU : E3/1 C2 A2 U3 - ACS : 10 ACCLY 004. TYPE: Single-lever. FLOW RATE: 20 l/mn. SPOUT PROJECTION: 156 - 168. CONNECTION: With connectors and wall escutcheons. MECHANISM: Ceramic disc cartridge. HOLE CONFIGURATION: 150 ± 15. SHOWER TAPS-DIVERTER: Automatic diverter with locking feature. MECHANISM GUARANTEE: 5 years. Non-return valve on shower outlet.

*Due to possible variations in computer and printer calibrations, technical factors and certain finish characteristics, the colors you see may not accurately portray the actual colors and are provided as a guide only.

www.jacobdelafon.com

This document is not contractual