



Collection: MALLECO

Finish*:



BL - Matte Black



CP - Chrome



VS - Brushed Stainless Steel

Main features:



Features

- **WEIGHT:** 2.4 kg
- **INSTALLATION TYPE:** 1 hole
- **HOSE TYPE:** Braided nylon hose
- **FLOW RATE:** 7 l/mn
- **SPOUT PROJECTION:** 229
- **SHOWER TAPS-WATER/ENERGY SAVING:** Yes
- **TYPE OF KITCHEN TAP:** MECHANICAL
- **MECHANISM GUARANTEE:** 5 years
- **WARRANTY DURATION (YEARS):** 5
- **MATERIAL:** N/A
- **NORMS AND REGULATIONS:** ACS : 15 ACC LY 765
- **TYPE:** Single-lever
- **HEIGHT UNDER SPOUT:** 383
- **CONNECTION:** With supply hoses
- **WASTE :** Without
- **SPOUT TYPE:** With pull-out spray
- **DRILLING:** Ø 35 mm

Consumer benefits

- **CUSTOMIZATION :** 3 interchangeable levers: black, white, taupe
- **PERFECT REPOSITIONING:** With DockNetick technology (magnets inside the spout), the pull-out sprayhead returns securely in place after use..

Installation benefits

- **QUICK FIX:** Threaded ring and 2 screws to secure in place.

Technical drawing

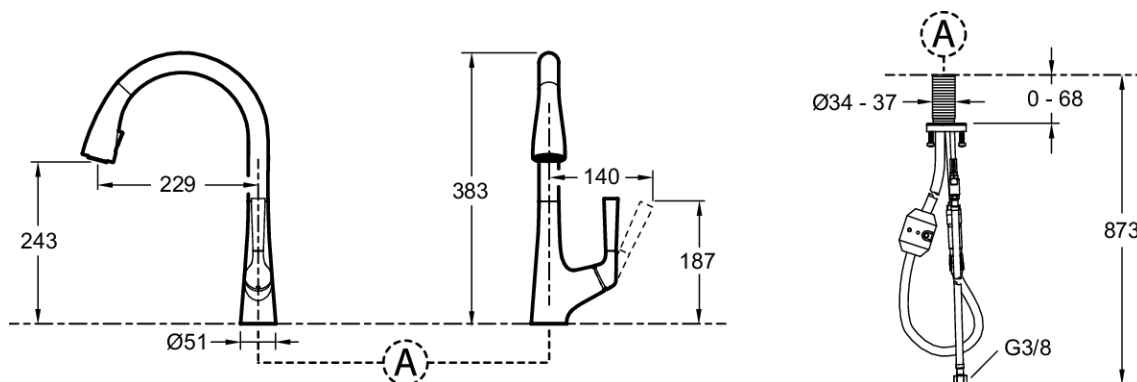

Product Specification: Single-lever kitchen sink mixer. E562. Collection: MALLECO. WEIGHT: 2.4 kg. MATERIAL: N/A. INSTALLATION TYPE: 1 hole. NORMS AND REGULATIONS: ACS : 15 ACC LY 765. HOSE TYPE: Braided nylon hose. TYPE: Single-lever. FLOW RATE: 7 l/mn. HEIGHT UNDER SPOUT: 383. SPOUT PROJECTION: 229. CONNECTION: With supply hoses. SHOWER TAPS-WATER/ENERGY SAVING: Yes. WASTE : Without. TYPE OF KITCHEN TAP: MECHANICAL. SPOUT TYPE: With pull-out spray. MECHANISM GUARANTEE: 5 years. DRILLING: Ø 35 mm. WARRANTY DURATION (YEARS): 5.