

E62322-F



Collection: FLIGHT PURE

Finish*:



00 - Gloss White

Main features:



Features

- **DIMENSIONS:** 80 x 80 x 2.60 cm
- **MATERIAL:** Flight
- **NORMS AND REGULATIONS:** CE
- **SHAPE:** Quadrant
- **WASTE SUPPLIED:** Yes
- Optional: Riser kit (height +10/13 cm), watertight strip.
- **WEIGHT:** 16 kg
- **INSTALLATION TYPE:** Raised, floorstanding or inset
- **ANTI-SLIP:** Yes
- **ADHERENCE:** PN 24 per NF standard
- **OPTIONAL RISER KIT:** Yes

Consumer benefits

- **ROBUSTNESS:** Flight material is very sturdy from dual-component resin topped with an acrylic layer, offering an excellent compromise between strenght, resistance and weight - High resistance to impacts: limited risk of chipping
- **UPSCALE AESTHETICS:** No unsightly waste cover at feet level; discreet, integrated slot wall side in the same colour as the shower tray.

Installation benefits

- **3 INSTALLATION OPTIONS:** Floorstanding, inset or raised, height 2.6 cm.
- **EASY INSTALLATION:** Virtually-straight corners for flush installation with tiling and dimensional accuracy to the nearest millimeter
- **ELEVATION:** Optional adjustable feet available.
- **WASTE:** Shower tray supplied with complete waste, water line 50 mm, 2 outlets (horizontal and vertical). Flow rate 29 L/min.

Optional products

- E62750: Riser kit without apron

Technical drawing

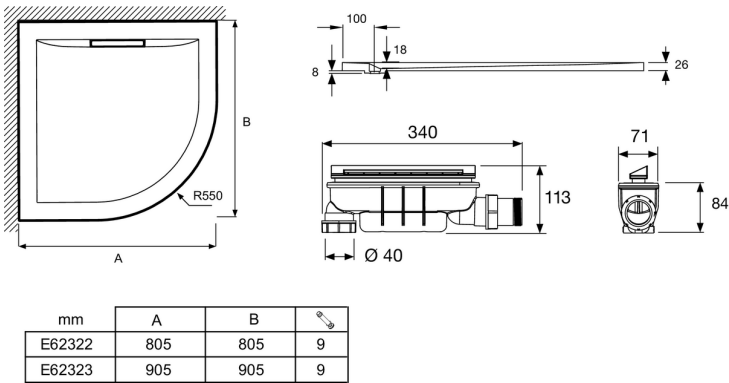

Product Specification: Quadrant anti-slip shower tray 80 cm. E62322-F. Collection: FLIGHT PURE. DIMENSIONS: 80 x 80 x 2.60 cm. WEIGHT: 16 kg. MATERIAL: Flight. INSTALLATION TYPE: Raised, floorstanding or inset. NORMS AND REGULATIONS: CE. ANTI-SLIP: Yes. SHAPE: Quadrant. ADHERENCE: PN 24 per NF standard. WASTE SUPPLIED: Yes. OPTIONAL RISER KIT: Yes. Optional: Riser kit (height +10/13 cm), watertight strip..

*Due to possible variations in computer and printer calibrations, technical factors and certain finish characteristics, the colors you see may not accurately portray the actual colors and are provided as a guide only.