

E62327



Collection: FLIGHT PURE

Finish*:



00 - Gloss White

Main features:



Features

- DIMENSIONS: 120 x 90 x 2.60 cm
- MATERIAL: Flight
- NORMS AND REGULATIONS: CE
- SHAPE: Rectangular
- WEIGHT: 32 kg
- INSTALLATION TYPE: Raised, floorstanding or inset
- ANTI-SLIP: No

Optional products

- E62751: Riser kit without apron
- E61428: Sealing kit
- E61426: Riser kit 90 x 90 cm
- E61429: Sealing kit

Technical drawing

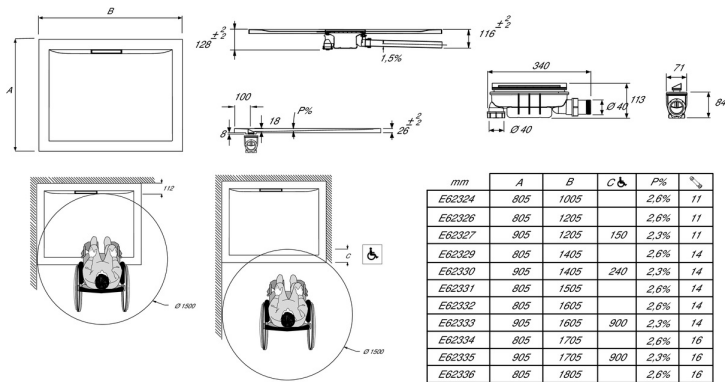

Product Specification: Rectangular shower tray 120 cm. E62327. Collection: FLIGHT PURE. DIMENSIONS: 120 x 90 x 2.60 cm. WEIGHT: 32 kg. MATERIAL: Flight. INSTALLATION TYPE: Raised, floorstanding or inset. NORMS AND REGULATIONS: CE. ANTI-SLIP: No. SHAPE: Rectangular.

*Due to possible variations in computer and printer calibrations, technical factors and certain finish characteristics, the colors you see may not accurately portray the actual colors and are provided as a guide only.