

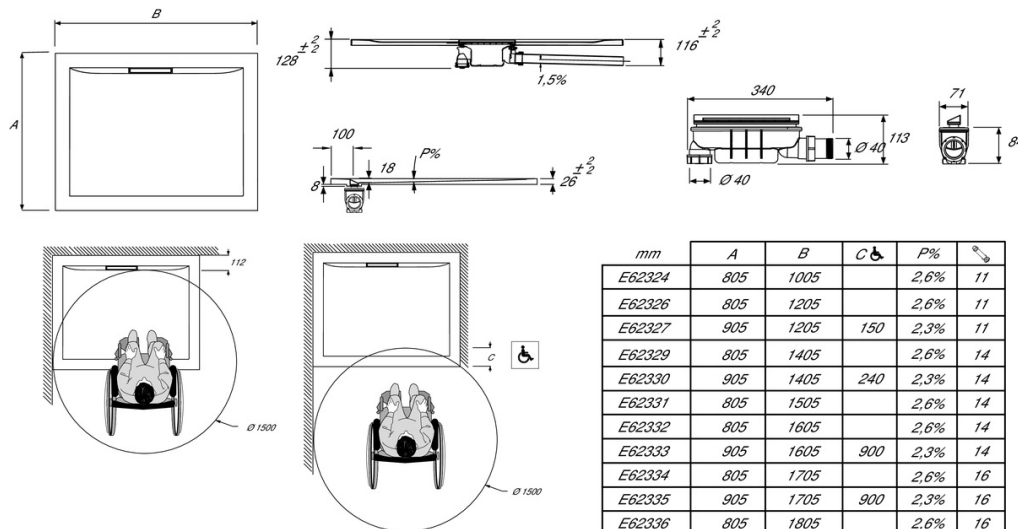

- **WEIGHT:** 40 kg
- **INSTALLATION TYPE:** Raised, floorstanding or inset
- **ANTI-SLIP:** No

- E61426: Riser kit 90 x 90 cm

Technical drawing



Product Specification: Rectangular shower tray 170 cm. E62334. Collection: FLIGHT PURE. DIMENSIONS: 170 x 80 x 2.60 cm. WEIGHT: 40 kg. MATERIAL: Flight. INSTALLATION TYPE: Raised, floorstanding or inset. NORMS AND REGULATIONS: CE. ANTI-SLIP: No. SHAPE: Rectangular.