



Collection: GALÉO CD

Finish*:



CP - Chrome

Main features:



Features

- **WEIGHT:** 1.3 kg
- **NORMS AND REGULATIONS:** NF : IB/A - EAU : E3/1 A1 U3 - ACS : 15ACCLY264
- **CONNECTION:** With connectors and wall escutcheons
- **SHOWER TAPS-DIVERTER:** Automatic diverter with locking feature
- Metal handles
- Non-return valve on shower outlet
- **INSTALLATION TYPE:** Wall-mount
- **TYPE:** Mixer
- **HOLE CONFIGURATION:** 150 ± 15
- **MECHANISM GUARANTEE:** 5 years
- Automatic diverter

Technical drawing

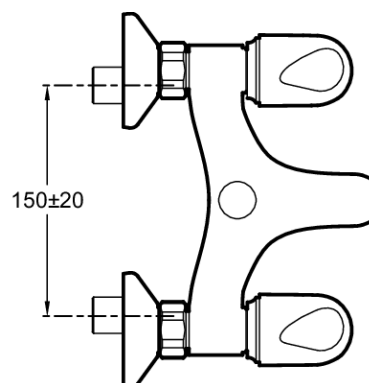
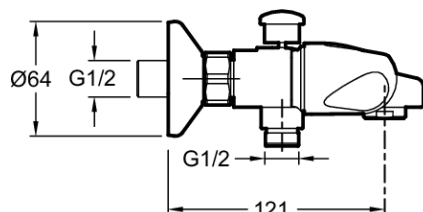

Product Specification: Wall bath/shower mixer. E71920. Collection: GALÉO CD. WEIGHT: 1.3 kg. INSTALLATION TYPE: Wall-mount. NORMS AND REGULATIONS: NF : IB/A - EAU : E3/1 A1 U3 - ACS : 15ACCLY264. TYPE: Mixer. CONNECTION: With connectors and wall escutcheons. HOLE CONFIGURATION: 150 ± 15. SHOWER TAPS-DIVERTER: Automatic diverter with locking feature. MECHANISM GUARANTEE: 5 years. Metal handles. Automatic diverter. Non-return valve on shower outlet.