



Collection: GALÉO CD

Finish*:



CP - Chrome

Main features:



Features

- **WEIGHT:** 1.4 kg
- **INSTALLATION TYPE:** 1 hole
- **TYPE:** Mixer
- **HEIGHT UNDER SPOUT:** 227
- **CONNECTION:** With supply hoses
- **MECHANISM GUARANTEE:** 5 years
- Metal/plastic waste
- **MATERIAL:** Metal
- **NORMS AND REGULATIONS:** NF : IIA - EAU : E1 A1 U3 - ACS : 15ACCLY265
- **FLOW RATE:** 15 l/mn
- **SPOUT PROJECTION:** 142
- **WASTE :** With
- Swivel tube sprout

Consumer benefits

- Anti-scale aerator
- **FINISH:** Chrome is guaranteed 10 years

Technical drawing

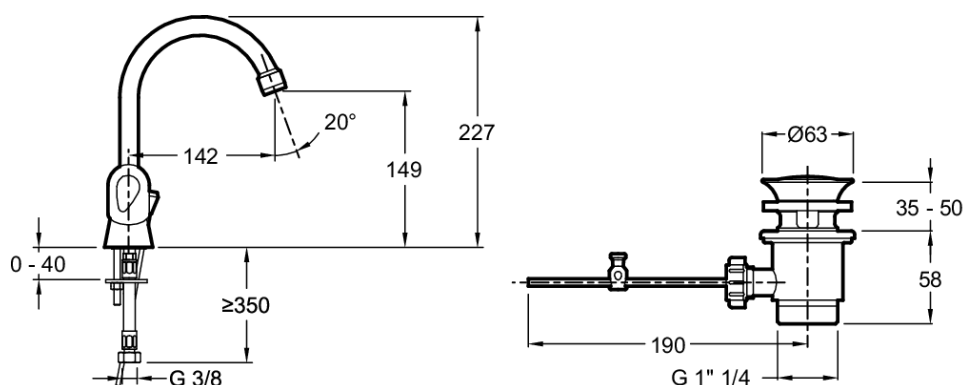

Product Specification: Washbasin mixer with supply hoses. E72920. Collection: GALÉO CD. WEIGHT: 1.4 kg. MATERIAL: Metal. INSTALLATION TYPE: 1 hole. NORMS AND REGULATIONS: NF : IIA - EAU : E1 A1 U3 - ACS : 15ACCLY265. TYPE: Mixer. FLOW RATE: 15 l/mn. HEIGHT UNDER SPOUT: 227. SPOUT PROJECTION: 142. CONNECTION: With supply hoses. WASTE: With. MECHANISM GUARANTEE: 5 years. Swivel tube sprout. Metal/plastic waste.