

## COMPOSED - 3-hole washbasin mixer - "Lever" handles

E73060-4

Jacob Delafon  
PARIS



Collection: COMPOSED

Finish\*:



CP - Chrome

Main features:



### Features

- WEIGHT: 4.5 kg
- INSTALLATION TYPE: 3 holes
- TYPE: Mixer
- HEIGHT UNDER SPOUT: 116
- MECHANISM: Ceramic disc valves
- SHOWER TAPS-WATER/ENERGY SAVING: Yes
- MECHANISM GUARANTEE: 5 years
- Lever handles
- MATERIAL: Metal
- NORMS AND REGULATIONS: ACS : 15 ACC LY 081
- FLOW RATE: 5 l/mn
- SPOUT PROJECTION: 151
- HOLE CONFIGURATION: 250 - 400
- WASTE : With
- 5
- Anti-scale aerator.

### Consumer benefits

- Metal waste with overlap cover

### Technical drawing

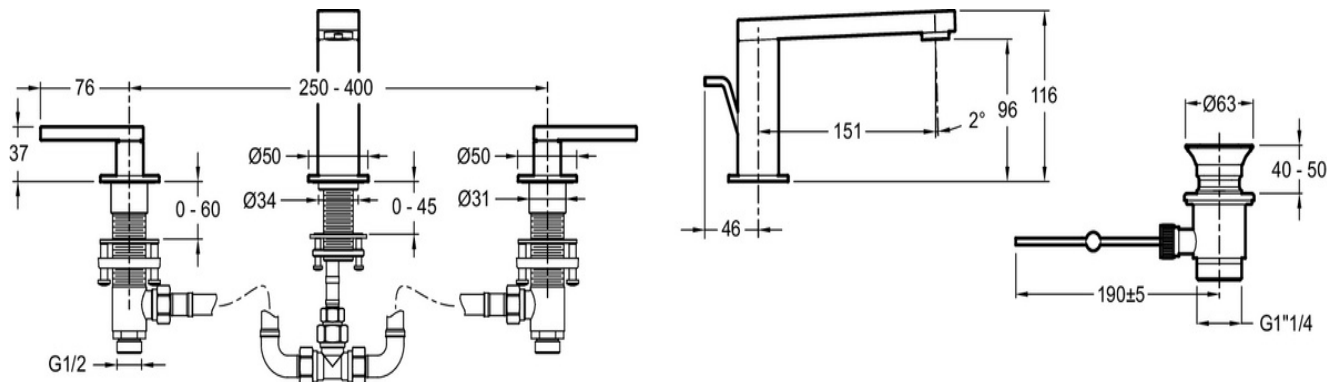

Product Specification: 3-hole washbasin mixer - "Lever" handles. E73060-4. Collection: COMPOSED. WEIGHT: 4.5 kg. MATERIAL: Metal. INSTALLATION TYPE: 3 holes. NORMS AND REGULATIONS: ACS : 15 ACC LY 081. TYPE: Mixer. FLOW RATE: 5 l/mn. HEIGHT UNDER SPOUT: 116. SPOUT PROJECTION: 151. MECHANISM: Ceramic disc valves. HOLE CONFIGURATION: 250 - 400. SHOWER TAPS-WATER/ENERGY SAVING: Yes. WASTE : With. MECHANISM GUARANTEE: 5 years. 5. Lever handles. Anti-scale aerator..

\*Due to possible variations in computer and printer calibrations, technical factors and certain finish characteristics, the colors you see may not accurately portray the actual colors and are provided as a guide only.

www.jacobdelafon.com

This document is not contractual