



Collection: COMPOSED

Finish\*:



CP - Chrome

Main features:



### Features

- **WEIGHT:** 12 kg
- **INSTALLATION TYPE:** Floor-mount
- **HOSE TYPE:** Smooth, anti-twist hose
- **FLOW RATE:** 24 l/mn
- **MECHANISM:** Ceramic disc cartridge
- **SHOWER TAPS-DIVERTER:** Automatic diverter at rear of spout
- 5

- **MATERIAL:** Brass
- **NORMS AND REGULATIONS:** ACS : 14 ACC LY 511
- **TYPE:** Single-lever
- **HEIGHT UNDER SPOUT:** 885 - 905
- **WASTE :** Without
- **MECHANISM GUARANTEE:** 5 years
- Install with floor base 97906D

### Consumer benefits

- **DESIGNED TO LAST:** One-piece, all brass mixer. Metal handle and cartridge pin provide greater resistance.

### Installation benefits

- **PROJECT INSTALLATION:** Base is built into floor first; mixer can be installed at the end of the project work.

### Required products

- 97906D: Recessed base

### Technical drawing

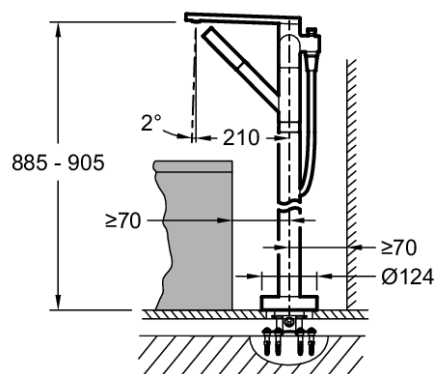
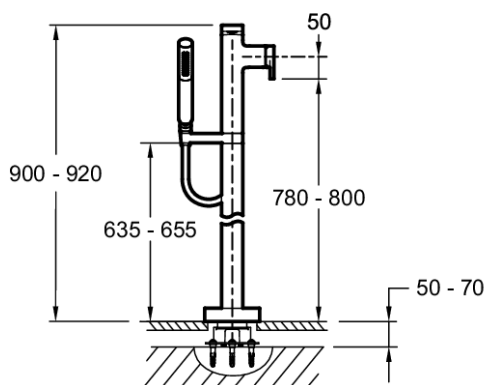

Product Specification: Single-lever bath/shower mixer. E73087. Collection: COMPOSED. WEIGHT: 12 kg. MATERIAL: Brass. INSTALLATION TYPE: Floor-mount. NORMS AND REGULATIONS: ACS : 14 ACC LY 511. HOSE TYPE: Smooth, anti-twist hose. TYPE: Single-lever. FLOW RATE: 24 l/mn. HEIGHT UNDER SPOUT: 885 - 905. MECHANISM: Ceramic disc cartridge. WASTE : Without. SHOWER TAPS-DIVERTER: Automatic diverter at rear of spout. MECHANISM GUARANTEE: 5 years. 5. Install with floor base 97906D.