

Collection: NATÉO

Finish*:



CP - Chrome

Main features:



Features

- **DIMENSIONS:** 21 x 29.50 cm
- **MATERIAL:** Metal
- **NORMS AND REGULATIONS:** NF : II - ECAU : E0 C2 A1 U3 - ACS : 11 ACCLY 540
- **FLOW RATE:** 9 l/mn
- **CONNECTION:** With supply hoses
- **SHOWER TAPS-WATER/ENERGY SAVING:** Yes
- **TYPE OF KITCHEN TAP:** MECHANICAL
- **MECHANISM GUARANTEE:** 5 years
- **WEIGHT:** 2.7 kg
- **INSTALLATION TYPE:** 1 hole
- **TYPE:** Single-lever
- **SPOUT PROJECTION:** 205
- **MECHANISM:** Ceramic disc cartridge
- **WASTE :** Without
- **SPOUT TYPE:** Fold-down spout
- For an elegant, functional installation under a window

Consumer benefits

- **ANTI-SCALE:** Aerator included
- Sensitive flow control

Technical drawing

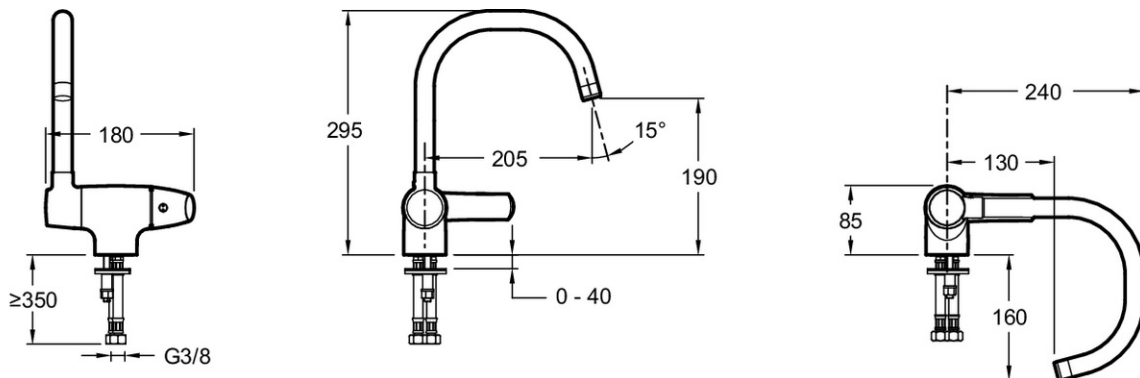

Product Specification: Single-lever kitchen sink mixer. E76250. Collection: NATÉO. DIMENSIONS: 21 x 29.50 cm. WEIGHT: 2.7 kg. MATERIAL: Metal. INSTALLATION TYPE: 1 hole. NORMS AND REGULATIONS: NF : II - ECAU : E0 C2 A1 U3 - ACS : 11 ACCLY 540. TYPE: Single-lever. FLOW RATE: 9 l/mn. SPOUT PROJECTION: 205. CONNECTION: With supply hoses. MECHANISM: Ceramic disc cartridge. SHOWER TAPS-WATER/ENERGY SAVING: Yes. WASTE : Without. TYPE OF KITCHEN TAP: MECHANICAL. SPOUT TYPE: Fold-down spout. MECHANISM GUARANTEE: 5 years. For an elegant, functional installation under a window.