



Collection: GRANDS BOULEVARDS

Finish\*:



CP - Chrome



BL - Matte Black



2MB - Brushed brass

Main features:



## Features

- **DIMENSIONS:** 4.80 x 17.60 cm
- **MATERIAL:** Brass
- **TYPE:** Single-lever
- **CONNECTION:** With supply hoses

- **WEIGHT:** 1 kg
- **INSTALLATION TYPE:** 1 hole
- **FLOW RATE:** 5 l/mn
- **WARRANTY DURATION (YEARS):** 5

## Consumer benefits

- **MONOGRAM:** Engraved with the Jacob Delafon monogram, marking the premium side of the range.
- **MINIMALISM:** A slender tapered handle.
- **CAREFUL DESIGN:** No rear cut-out for a genuinely harmonious product design.
- **WATER SAVING:** If you prefer to reduce your daily water consumption while maintaining a comfortable use, this washbasin faucet with a 5l/min flow rate is ideal.

## Installation benefits

- **SAFE INSTALLATION:** Installation system with threaded rod.

## Technical drawing

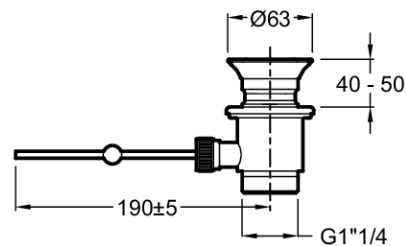
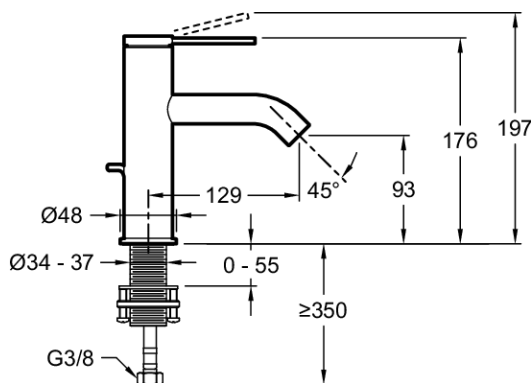

Product Specification: Single-lever washbasin mixer. E77958-4A. Collection: GRANDS BOULEVARDS. DIMENSIONS: 4.80 x 17.60 cm. WEIGHT: 1 kg. MATERIAL: Brass. INSTALLATION TYPE: 1 hole. TYPE: Single-lever. FLOW RATE: 5 l/mn. CONNECTION: With supply hoses. WARRANTY DURATION (YEARS): 5.