



Collection: BRIVE

Finish\*:



CP - Chrome

Main features:



### Features

- **DIMENSIONS:** 25.90 x 4.70 cm
- **MATERIAL:** Metal
- **NORMS AND REGULATIONS:** NF : E00 Ch3 A3 U3 - ACS : 15 ACC LY 472
- **FLOW RATE:** 5 l/mn
- **SPOUT PROJECTION:** 150
- **MECHANISM:** Ceramic disc cartridge
- **MECHANISM GUARANTEE:** 5 years
- **WEIGHT:** 1.2 kg
- **INSTALLATION TYPE:** 1 hole
- **TYPE:** Single-lever
- **HEIGHT UNDER SPOUT:** 259
- **CONNECTION:** With supply hoses
- **WASTE :** With
- **DRILLING:** Ø 35 mm

### Consumer benefits

- **EASY CARE:** Anti-scale aerator
- **PRACTICAL:** Tall swivel tube spout

### Installation benefits

- **INSTALLATION IN 35°:** product equipped with patented 5/35° system for fast, easy installation
- **SMALL SPACES:** Side lift rod makes installation easier, even in small spaces.

### Technical drawing

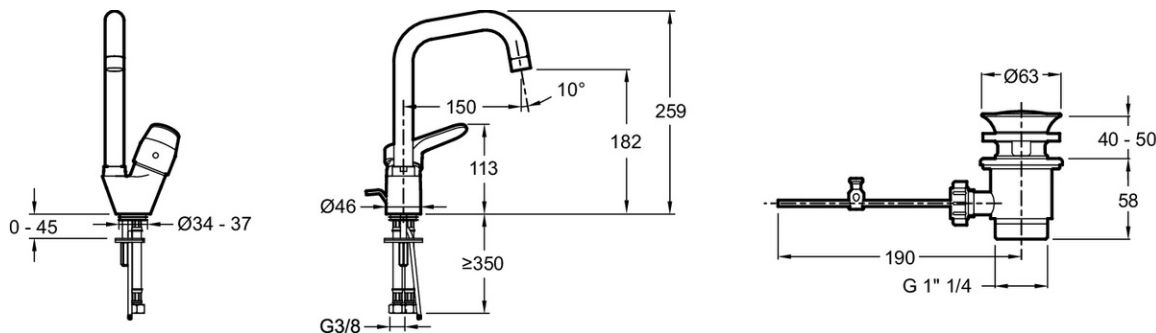

Product Specification: Tall single-lever washbasin mixer. E78116-4. Collection: BRIVE. DIMENSIONS: 25.90 x 4.70 cm. WEIGHT: 1.2 kg. MATERIAL: Metal. INSTALLATION TYPE: 1 hole. NORMS AND REGULATIONS: NF : E00 Ch3 A3 U3 - ACS : 15 ACC LY 472. TYPE: Single-lever. FLOW RATE: 5 l/mn. HEIGHT UNDER SPOUT: 259. SPOUT PROJECTION: 150. CONNECTION: With supply hoses. MECHANISM: Ceramic disc cartridge. WASTE : With. MECHANISM GUARANTEE: 5 years. DRILLING: Ø 35 mm.