



Collection: JULY

Finish*:



CP - Chrome

Main features:



Features

- **WEIGHT:** 1.4 kg
- **INSTALLATION TYPE:** 1 hole
- **TYPE:** Single-lever
- **CONNECTION:** With supply hoses
- **SHOWER TAPS-WATER/ENERGY SAVING:** Yes
- **TYPE OF KITCHEN TAP:** MECHANICAL
- **MECHANISM GUARANTEE:** 5 years
- Swivel tube spout
- **MATERIAL:** Metal
- **NORMS AND REGULATIONS:** NF : I - ECAU : E0 C3 A2 U3 (Ge5) - ACS : 11 ACCLY 540
- **FLOW RATE:** 10 l/mn
- **MECHANISM:** C3 ceramic disc water- and energy-efficient cartridge
- **WASTE :** Without
- **SPOUT TYPE:** Pivot spout
- **DRILLING:** Ø 35 mm

Consumer benefits

- **ANTI-SCALE:** Aerator included
- Sensitive flow control

Installation benefits

- **DURABILITY:** High resistance PEX supply hoses
- Standard hole Ø 35 mm.

Technical drawing

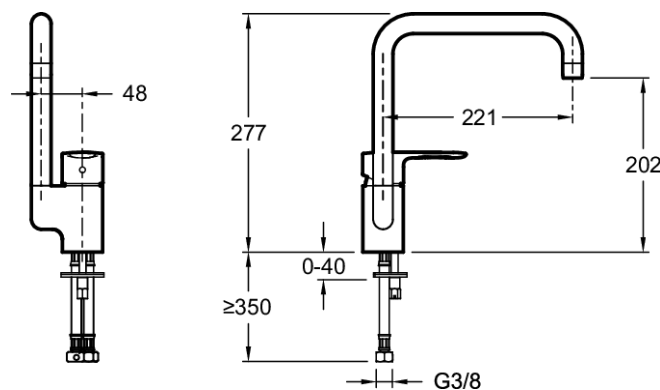

Product Specification: Single-lever kitchen sink mixer. E98325. Collection: JULY. WEIGHT: 1.4 kg. MATERIAL: Metal. INSTALLATION TYPE: 1 hole. NORMS AND REGULATIONS: NF : I - ECAU : E0 C3 A2 U3 (Ge5) - ACS : 11 ACCLY 540. TYPE: Single-lever. FLOW RATE: 10 l/mn. CONNECTION: With supply hoses. MECHANISM: C3 ceramic disc water- and energy-efficient cartridge. SHOWER TAPS-WATER/ENERGY SAVING: Yes. WASTE : Without. TYPE OF KITCHEN TAP: MECHANICAL. SPOUT TYPE: Pivot spout. MECHANISM GUARANTEE: 5 years. DRILLING: Ø 35 mm. Swivel tube spout.