



Collection: JULY

Finish\*:



CP - Chrome

Main features:

### Features

- **DIMENSIONS:** 24.50 x 16.50 x 11.50 cm
- **MATERIAL:** Metal
- **NORMS AND REGULATIONS:** ACS (Certificate of Sanitary Compliance): 10 ACC LY 004
- **TYPE:** Single-lever
- **WEIGHT:** 2.6 kg
- **INSTALLATION TYPE:** Built-in
- **FLOW RATE:** 25-29 l/min
- Automatic diverter with locking option

### Required products

- 98699D: Universal recessed box

### Technical drawing

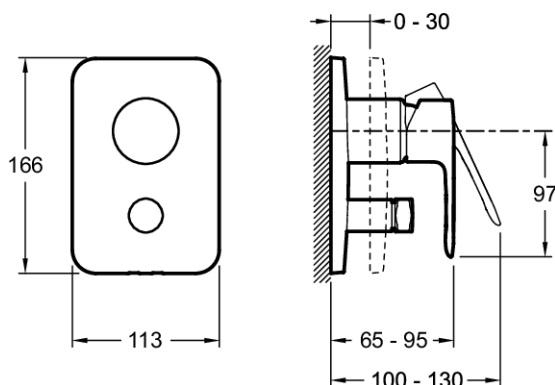

Product Specification: Two-way shower mixer. E98714. Collection: JULY. DIMENSIONS: 24.50 x 16.50 x 11.50 cm. WEIGHT: 2.6 kg. MATERIAL: Metal. INSTALLATION TYPE: Built-in. NORMS AND REGULATIONS: ACS (Certificate of Sanitary Compliance): 10 ACC LY 004. FLOW RATE: 25-29 l/min. TYPE: Single-lever. Automatic diverter with locking option.