



Collection: ALEO

Finish*:



CP - Chrome

Main features:

Features

- **DIMENSIONS:** 24.50 x 16.50 x 11.50 cm
- **MATERIAL:** Metal
- **FLOW RATE:** 25-29 l/min
- **COMPONENTS:** Build-in body, trim and handle
- **WEIGHT:** 2.6 kg
- **INSTALLATION TYPE:** Built-in
- **TYPE:** Single-lever
- **CONNECTIONS:** Connect to two outlets (exqmples: showerhead, handshower, bath spout)

Consumer benefits

- **SIMPLE FUNCTIONALITY:** Automatic diverter with locking option
- **EVACUATION SYSTEM:** Prevents condensation inside the Modulo box
- **EASY GRIP:** Aleo ergonomic handle

Installation benefits

- **FAST INSTALLATION:** Fixing screws pre-mounted to cartridge box
- **EASY INSTALLATION:** Thanks to guide notches
- **CONVENIENT MAINTENANCE:** Easy access to build-in body (thermostatic cartridge, non-return valves, etc.)

Required products

- 98699D: Universal recessed box

Technical drawing

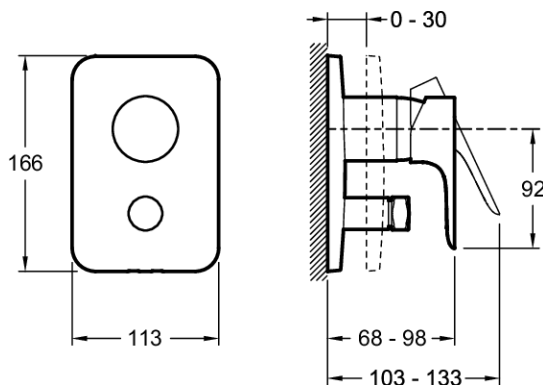

Product Specification: Built-in shower mixer with diverter. E98717. Collection: ALEO. DIMENSIONS: 24.50 x 16.50 x 11.50 cm. WEIGHT: 2.6 kg. MATERIAL: Metal. INSTALLATION TYPE: Built-in. FLOW RATE: 25-29 l/min. TYPE: Single-lever. COMPONENTS: Build-in body, trim and handle. CONNECTIONS: Connect to two outlets (exqmples: showerhead, handshower, bath spout).