



Collection: TOOBI

Finish*:



CP - Chrome

Main features:

Features

- **WEIGHT:** 2.5 kg
- **INSTALLATION TYPE:** Built-in
- **FLOW RATE:** 25-29 l/min
- Automatic diverter with locking option
- **MATERIAL:** Metal
- **NORMS AND REGULATIONS:** ACS (Certificate of Sanitary Compliance): 10 ACC LY 004
- **TYPE:** Single-lever

Consumer benefits

- Natural water FLOW
- Flow REGULATOR

Required products

- 98699D: Universal recessed box

Technical drawing

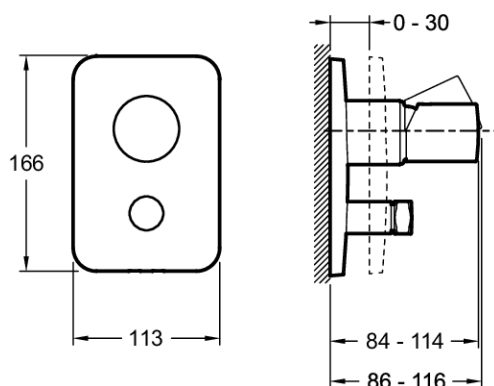

Product Specification: Two-way shower mixer. E98719. Collection: TOOBI. WEIGHT: 2.5 kg. MATERIAL: Metal. INSTALLATION TYPE: Built-in. NORMS AND REGULATIONS: ACS (Certificate of Sanitary Compliance): 10 ACC LY 004. FLOW RATE: 25-29 l/min. TYPE: Single-lever. Automatic diverter with locking option.