



Collection: KUMIN

Finish*:



CP - Chrome

Main features:



Features

- **WEIGHT:** 1.3 kg
- **INSTALLATION TYPE:** Wall-mount
- **FLOW RATE:** 12 l/mn
- **HOLE CONFIGURATION:** 150 ± 15
- Non-return valve on the shower outlet.
- **MATERIAL:** Metal
- **TYPE:** Single-lever
- **CONNECTION:** With connectors and wall escutcheons
- **MECHANISM GUARANTEE:** 5 years

Consumer benefits

- **WATER SAVING:** Flow rate limited to 12 l/min
- **HYGIENE:** A non-return valve on the shower outlet to avoid pollution of the pipes.

Installation benefits

- **EASY TO INSTALL:** Wall-mounted fittings and brackets

Technical drawing

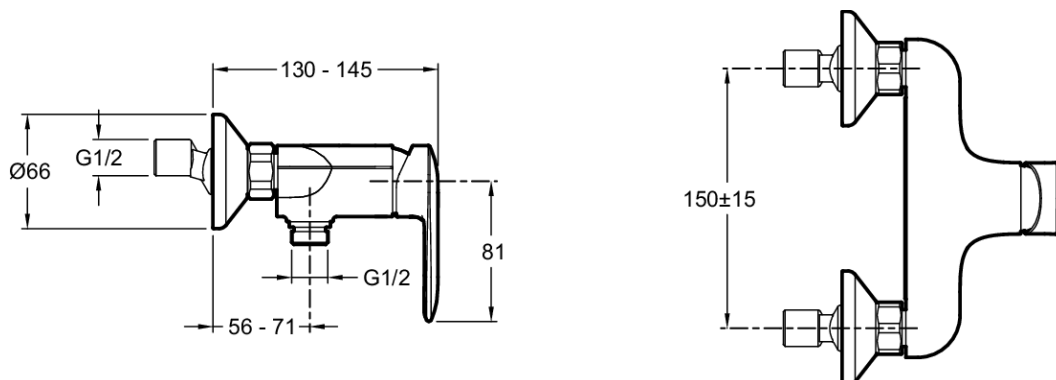

Product Specification: Single-lever wall-mount shower mixer. E99463. Collection: KUMIN. WEIGHT: 1.3 kg. MATERIAL: Metal. INSTALLATION TYPE: Wall-mount. TYPE: Single-lever. FLOW RATE: 12 l/mn. CONNECTION: With connectors and wall escutcheons. HOLE CONFIGURATION: 150 ± 15. MECHANISM GUARANTEE: 5 years. Non-return valve on the shower outlet..