

KUMIN - Single-lever washbasin mixer - Standard - C3 cartridge

E99981

Jacob Delafon
PARIS



Collection: KUMIN

Finish*:



CP - Chrome

Main features:



Features

- **WEIGHT:** 1.4 kg
- **NORMS AND REGULATIONS:** NF ECAU : E0 C3 A2 U3 - (Ge5) - ACS (Attestation Conformité Sanitaire) : 10 ACC LY 113
- **FLOW RATE:** 11 l/mn
- **SPOUT PROJECTION:** 100
- **MECHANISM:** C3 water- and energy-saving cartridge
- **MECHANISM GUARANTEE:** 5 years

Consumer benefits

- Built-in anti-scale aerator: Easy replacement with no special tool (you can use a coin) and easier cleaning
- Water flows through the faucet body with no contact with chrome or nickel: Hygiene, safety and savings

- **INSTALLATION TYPE:** 1 hole
- **TYPE:** Single-lever
- **HEIGHT UNDER SPOUT:** 132
- **CONNECTION:** With supply hoses
- **WASTE :** With
- Height under aerator: 63 mm

Installation benefits

- **SIDE LIFT ROD:** Easy to install on small washbasins, better accessibility for user
- **EASIER INSTALLATION:** Pre-assembled hoses

Technical drawing

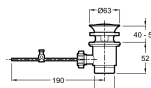
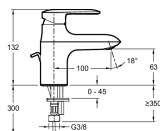

Product Specification: Single-lever washbasin mixer - Standard - C3 cartridge. E99981. Collection: KUMIN. WEIGHT: 1.4 kg. INSTALLATION TYPE: 1 hole. NORMS AND REGULATIONS: NF ECAU : E0 C3 A2 U3 - (Ge5) - ACS (Attestation Conformité Sanitaire) : 10 ACC LY 113. TYPE: Single-lever. FLOW RATE: 11 l/mn. HEIGHT UNDER SPOUT: 132. SPOUT PROJECTION: 100. CONNECTION: With supply hoses. MECHANISM: C3 water- and energy-saving cartridge. WASTE : With. MECHANISM GUARANTEE: 5 years. Height under aerator: 63 mm.

*Due to possible variations in computer and printer calibrations, technical factors and certain finish characteristics, the colors you see may not accurately portray the actual colors and are provided as a guide only.

www.jacobdelafon.com

This document is not contractual