



**Collection:** NOUVELLE VAGUE

**Finish\*:**



N18 - Gloss White  
melamine

**Main features:**



## Features

- **DIMENSIONS:** 45.20 x 30 x 46.80 cm
- **MATERIAL:** Melamine
- **COLORIS POIGNÉE:** Noir Mat
- **WEIGHT:** 19.9 kg
- **INSTALLATION TYPE:** Wall-hung
- **WARRANTY DURATION (YEARS):** 5

## Technical drawing

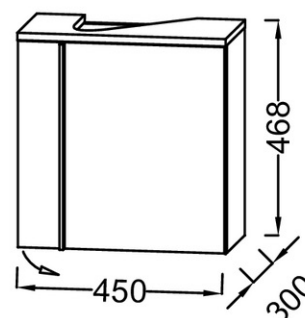
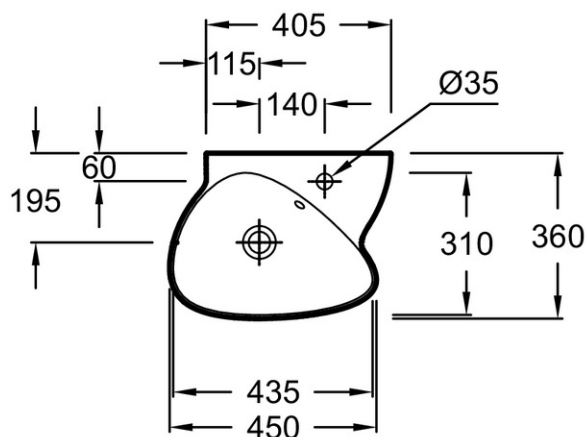

Product Specification: Base unit + handwash basin. EBP3045D. Collection: NOUVELLE VAGUE. DIMENSIONS: 45.20 x 30 x 46.80 cm. WEIGHT: 19.9 kg. MATERIAL: Melamine. INSTALLATION TYPE: Wall-hung. COLORIS POIGNÉE: Noir Mat. WARRANTY DURATION (YEARS): 5.